

# easySCOPE

Version 12/17



FOREIGN BODY DETECTOR FOR PACKAGED GOODS

## TECHNICAL DATASHEET

# DIMENSIONS easySCOPE 400

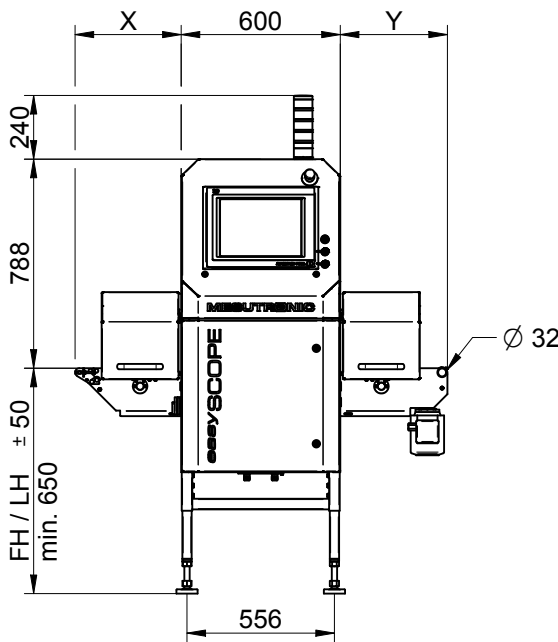

Förderrichtung  
conveying direction →

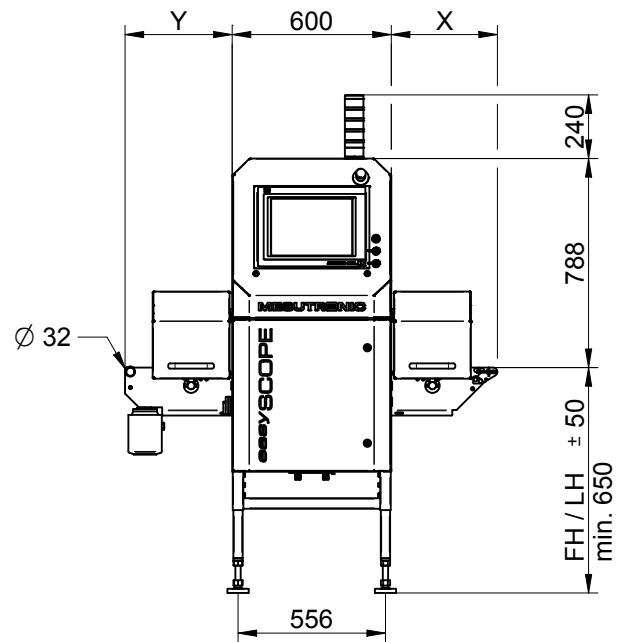

Förderrichtung  
← conveying direction

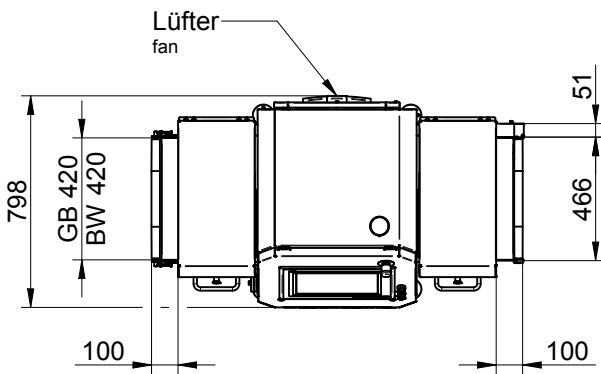

Bedienseite  
operator side

## empfindlicher Bereich sensitive area

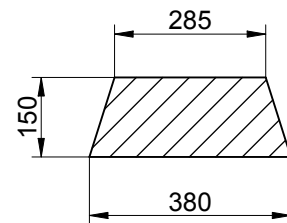

PRODUCT HEIGHT	PRODUCT WIDTH
0	380
30	360
60	340
90	325
120	305
150	285

Förderbandlängen - conveyor length					
X	400 *	600	800	1000	1200
Y	400 *	600	800 *	1000	1200

\* Standardlänge  
standard length

Förderhöhen FH - line heights LH									
Stellfüße - adjustable foot	650	700	750	800	850	900	950	1000	1050
Fahrrollen - castor wheels	-	-	-	800	850	900	950	1000	1050

# DIMENSIONS easySCOPE 600

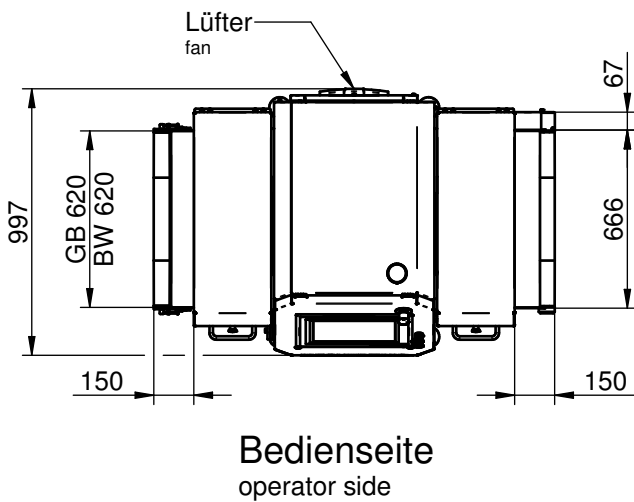
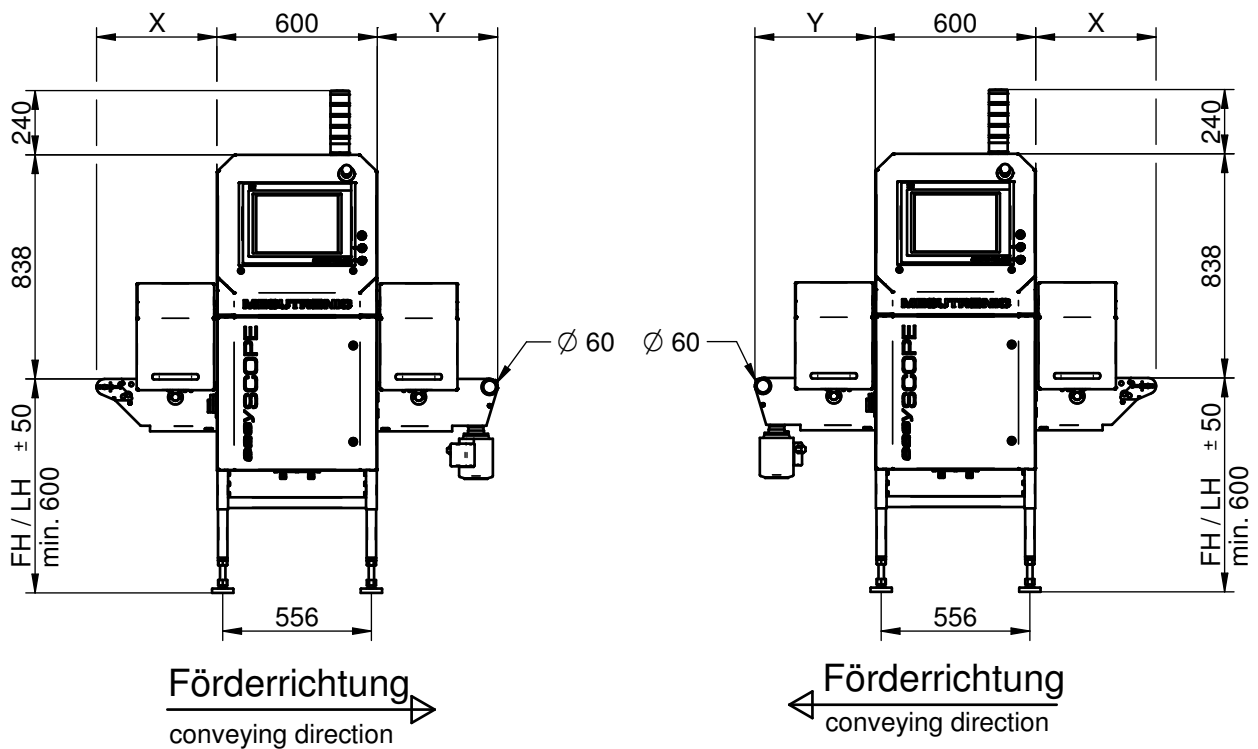

## empfindlicher Bereich sensitive area

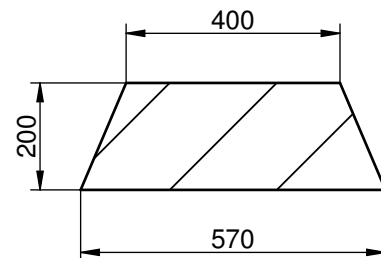

PRODUCT HEIGHT	PRODUCT WIDTH
0	570
30	545
60	520
90	495
120	470
150	445
180	415
200	400

Förderbandlängen - conveyor length					
X	450 *	650	850	1050	1250
Y	450 *	650	850 *	1050	1250

\* Standardlänge  
standard length

Förderhöhen FH - line heights LH									
Stellfüße - adjustable foot	600	650	700	750	800	850	900	950	1000
Fahrrollen - castor wheels	-	-	-	750	800	850	900	950	1000

## TECHNICAL DATA

HOUSING:	STAINLESS STEEL 304, SANDBLASTED	
PROTECTION CLASS:	HOUSING IP 54; CONVEYOR IP 65	
AMBIENT TEMPERATURE:	+ 5 °C TO + 28 °C WITH FILTER FAN + 5 °C bis + 40 °C WITH AIR COOLING	
STORAGE TEMPERATURE:	- 10°C TO + 60°C	
RELATIVE HUMIDITY:	UP TO 90% (WITHOUT CONDENSATION WATER)	
OPERATING VOLTAGE:	230 V ± 10% AC, 50-60 Hz	
MAINS PROTECTION:	10 A	
POWER CONSUMPTION:	670 W WITH FILTER FAN 840 W WITH AIR COOLING	
MAINS CONNECTION:	APPROX. 3 M CABLE WITH SAFETY PLUG	
X-RAY GENERATOR:	80 KV / 5 MA, MAX. 210 W	
X-RAY DETECTOR:	410 MM, EFFECTIVE DIODE SIZE 0,8 MM	614 MM, EFFECTIVE DIODE SIZE 0,8 MM
X-RAY EMISSION:	< 0,5 µSv/h	
RADIATION PROTECTION CURTAIN:	LEAD-FREE RUBBER MATRIX WITH BACKING FABRIC, BLACK APPROVED FOR FOOD ACCORDING TO FDA	
CONVEYING SPEED: <sup>1</sup>	0,1 m/s TO 1,2 m/s	
BELT WIDTH:	420 MM	620 MM
BELT MATERIAL:	POLYURETHANE, WHITE APPROVED FOR FOOD ACCORDING TO FDA, USDA, EU	
LOAD:	MAX. 5 KG AT V = 1,2 M/S MAX. 10 KG AT V = 0,6 M/S	MAX. 10 KG AT V = 1,2 M/S MAX. 20 KG AT V = 0,6 M/S
WEIGHT:	300 KG	500 KG

## STANDARD SCOPE OF DELIVERY

- FOREIGN BODY DETECTOR WITH INTEGRATED BELT CONVEYOR SYSTEM
- QUICK-RELEASE-SYSTEM FOR BELT CLEANING
- 4 COLOR LED SIGNAL TOWER
- INDUSTRIAL PC WITH 15,4" FLAT MONITOR AND TOUCH SCREEN
- HIGH PERFORMANCE IMAGING SOFTWARE
- UNINTERRUPTIBLE POWER SUPPLY
- FILTER FAN
- COMPREHENSIVE SECURITY AND CONTROL PACKAGE  
(SECURITY SWITCH, PLC, FREQUENCY CONVERTER, ETC.)
- USER MANUAL INCL. INSTALLATION INSTRUCTIONS, WIRING DIAGRAM  
AND SPARE PARTS LIST IN SEVERAL LANGUAGES
- EC CONFORMITY DECLARATION

<sup>1</sup>THE NOMINAL SPEED IS ± 40 % ADJUSTABLE AND HAS TO BE DEFINED FOR EACH PROJECT.

## DELIVERABLE OPTIONS

- WATER JET-PROTECTIVE COVERS FOR FILTER FAN AND AMBIENT TEMPERATURE UP TO 28°C (IP 55)
- AIR COOLING SYSTEM FOR AMBIENT TEMPERATURE UP TO 40°C (IP 34)
- AIR COOLING SYSTEM FOR AMBIENT TEMPERATURE UP TO 40°C AND CLEANING-INTENSIVE ENVIRONMENTS (IP65)
- ACOUSTICAL SIGNALLING DEVICE
- REJECT SYSTEMS: PUSHER, AIR JET, ONLY easySCOPE 600: FLAP
- SIDE GUIDES
- LOCKABLE CONTAINER FOR REJECTED PRODUCT
- SAFETY COVER: STAINLESS STEEL OR MAKROLON
- HIGH-RESOLUTION X-RAY DETECTOR (EFFECTIVE DIODE SIZE 0,4 MM)
- CASTOR WHEELS

# MESUTRONIC

*Metal Detection made in Germany*

MESUTRONIC Gerätebau GmbH · Hackenfeld 13 · 94259 Kirchberg im Wald · Germany  
Tel. +49 9927 9410-0 · Fax +49 9927 1732  
sales@mesutronic.de · www.mesutronic.de